



T-1 LIGHTING

Project	Catalog #
Distributor	Type
Prepared by	Date

AURORA RETROFIT SERIES T1-AUR

Our **AURORA** downlight is a top-quality residential lighting solution that offers even illumination without any halo or shadows. It is equipped with the best-in-class 120V drivers to ensure energy efficiency. The fixture boasts a PC driver housing and an aluminum reflector with an architectural white finish. The AURORA downlight features three wattage and five CCT selectable options. Offer continuous dimming to 5% with many Triac Dimmers and can be easily clipped into existing 4" and 5/6" compatible housing without requiring any additional accessories making it a versatile lighting option for any space.



SPEC

Model Number	Input Power	Color Temp	Input Voltage	Lumens	Efficacy	Temp	CRI	PG
T1-AUR/4/MW12-MCCT	Multi Watt 8/10/12W	MCCT	120V	579 - 679 - 847 643 - 776 - 925 632 - 760 - 903 560 - 712 - 827 553 - 658 - 801	100	-40°C ~ +40°C -40°F ~ +104°F	>90	N/A
T1-AUR/6/MW18-MCCT	Multi Watt 12/15/18W			784 - 973 - 1056 851 - 1071 - 1176 921 - 1196 - 1303 952 - 1219 - 1339 877 - 1086 - 1187				

WARRANTY: FIVE YEAR PARTS

ORDERING OPTIONS

Series	Form Factor	Wattage	Color Temp	Voltage	Dimming	Backup	Controls
T1-AUR	/6	/MW18	-MCCT				
T1-AUR	4" 4" 6" 6"	4" MW8 8W MW10 10W MW12 12W 6" MW12 12W MW15 15W MW18 15W	-MCCT 2700K 3000K 3500K 4000K 5000K	[BLANK] 120-277V	[BLANK] 0-10V	[BLANK] None	[BLANK] None

DIMENSIONS

4"

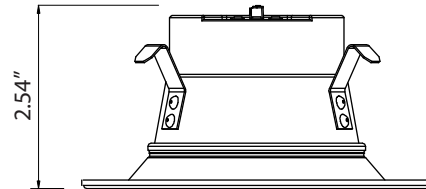
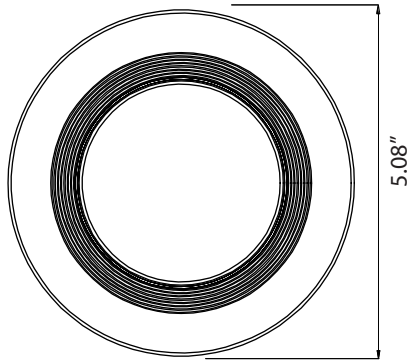

6"

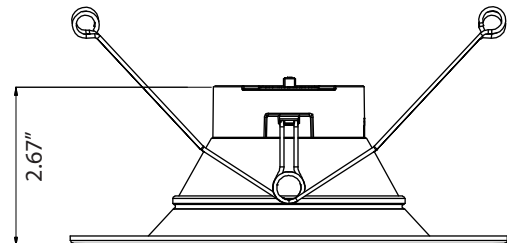
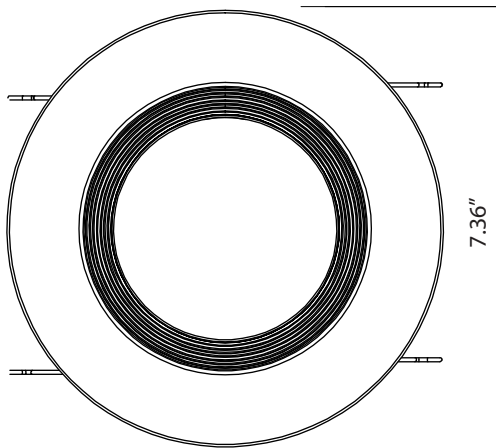

INSTALLATION

WARNING

Turn off electricity at main fuse box (or circuit breaker box) before beginning installation by removing Fuse (or switching off circuit breaker).

Be careful not to damage or cut the wire insulation (covering) during fixture installation. Do not permit power cord or housing to contact any surface having a sharp edge. To do so may damage or cut the wire insulation, which could cause serious injury or death from electric shock.

This fixture requires 120-277V power input. The installer must confirm the input power at the source prior to installation.

Step 1:

Screw the E26 socket adapter into the existing socket. (Fig1)

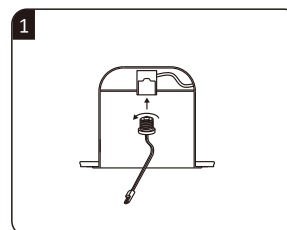

INSTALLATION - CONT.

Step 2:

Connect the terminals from E26 socket adapter to the fixture. (Fig2, Fig5).

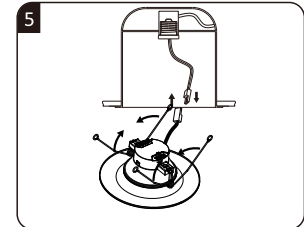
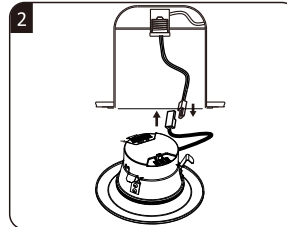

For 4" Retrofit

Step 3:

Push fixture up into can, ensuring it is flush with ceiling. (Fig3)

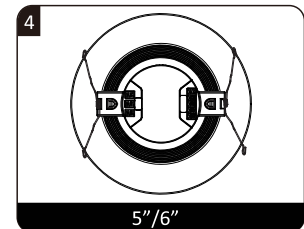
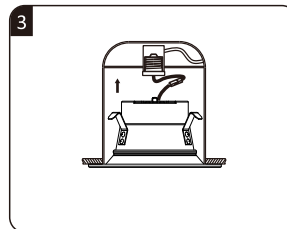

For 6" Retrofit

Step 3:

Press spring clips together, push fixture up into can and release once in, continue pushing until flush with ceiling. (Fig6)

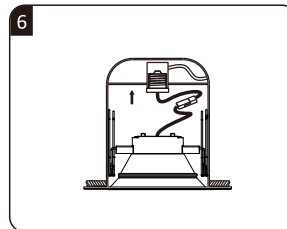

CONTROL SELECTION

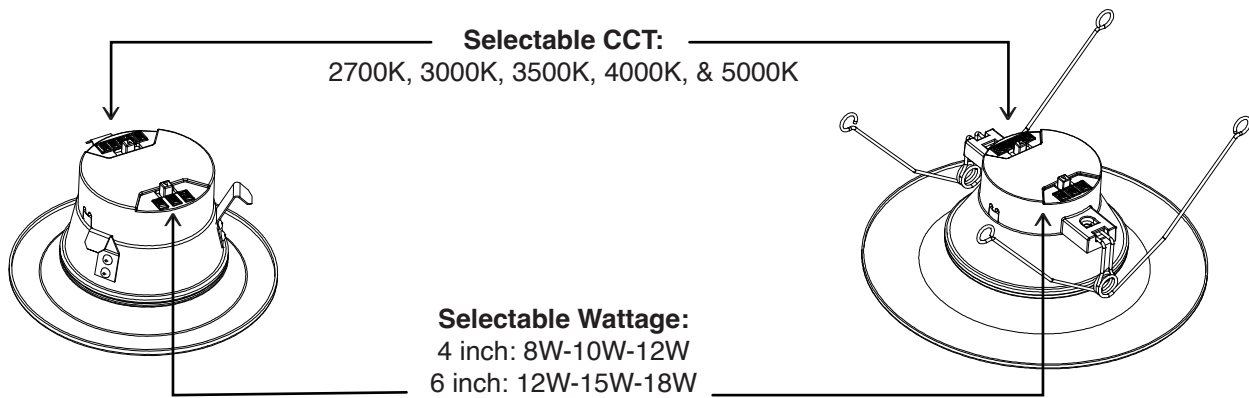

ACCESSORIES INCLUDED



E26 Adapter

PHOTOMETRIC DATA

PHOTOMETRIC DATA 4" - 12W

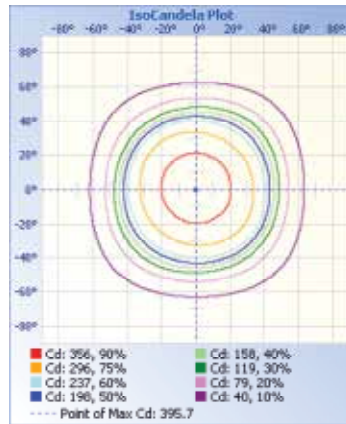
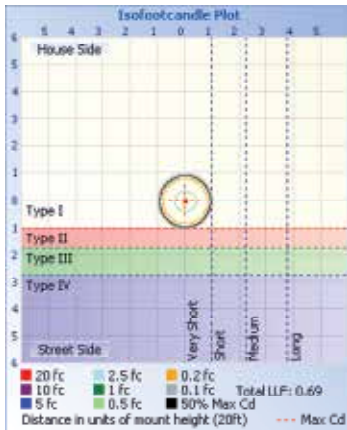

Illuminance at a Distance

Center Beam Fc	Beam Width
17.0ft	1.37 fc 31.5 ft 31.4 ft
34.0ft	0.34 fc 63.0 ft 62.8 ft
51.0ft	0.15 fc 94.5 ft 94.3 ft
68.0ft	0.09 fc 126.0 ft 125.7 ft
85.0ft	0.05 fc 157.4 ft 157.1 ft
102.0ft	0.04 fc 188.9 ft 188.5 ft

Vert. Spread: 85.6°
 Horiz. Spread: 85.5°

PHOTOMETRIC DATA 6" - 18W

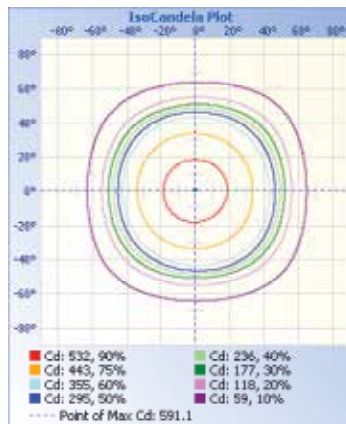
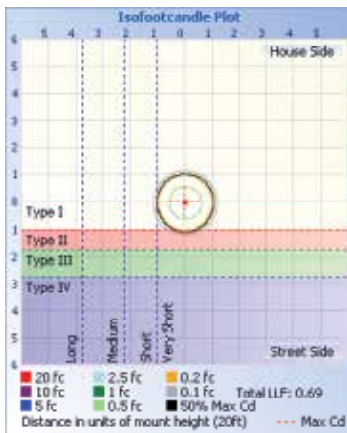

Illuminance at a Distance

Center Beam Fc	Beam Width
17.0ft	2.04 fc 35.8 ft 35.1 ft
34.0ft	0.51 fc 71.5 ft 70.1 ft
51.0ft	0.23 fc 107.3 ft 105.2 ft
68.0ft	0.13 fc 143.0 ft 140.3 ft
85.0ft	0.08 fc 178.8 ft 175.3 ft
102.0ft	0.06 fc 214.6 ft 210.4 ft

Vert. Spread: 92.9°
 Horiz. Spread: 91.6°