



T-1 LIGHTING

|             |           |
|-------------|-----------|
| Project     | Catalog # |
| Distributor | Type      |
| Prepared by | Date      |

# FLASH RELIABLE EMERGENCY DRIVERS T1-EM-B



- UL listed
- Listed for UL924 and tested to CSA C22.2 No. 141 field or factory installation
- High output voltage
- Low energy consumption CEC compliance
- Constant power output
- Self-testing
- Battery with over temperature protection

SPECS

|                    |                            |                     |                            |
|--------------------|----------------------------|---------------------|----------------------------|
| Input Voltage      | 100~277Vac/347Vac, 50/60Hz | Discharge Time      | ≥1.5H                      |
| Input Current      | 100mA max.                 | Warranty            | 5 Years                    |
| Input Power Rating | 7W max                     | Ambient Temperature | Li-ion: 32°~122°F(0°~50°C) |
| Output Voltage     | 25-230Vdc                  | Weight              | 0.908 lbs. (0.41kg.)       |
| Emergency Power    | 30W max.                   | Surge Protection    | Line-Neutral 3KV           |
| Recharge Time      | 24Hrs.                     |                     |                            |



| MODEL NO.    | OUTPUT VOLTAGE | EMERGENCY POWER | BATTERY TYPE |
|--------------|----------------|-----------------|--------------|
| T1-EM-B8-50  | 25-50Vdc       | 8W              | Li-ion       |
| T1-EM-B15-50 |                | 15W             |              |
| T1-EM-B20-50 |                | 20W             |              |
| T1-EM-B30-50 |                | 30W             |              |
| T1-EM-B8-80  | 51-80Vdc       | 8W              |              |
| T1-EM-B15-80 |                | 15W             |              |
| T1-EM-B20-80 |                | 20W             |              |
| T1-EM-B30-80 |                | 30W             |              |

| MODEL NO.     | OUTPUT VOLTAGE | EMERGENCY POWER | BATTERY TYPE |
|---------------|----------------|-----------------|--------------|
| T1-EM-B8-155  | 81-155Vdc      | 8W              | Li-ion       |
| T1-EM-B15-155 |                | 15W             |              |
| T1-EM-B20-155 |                | 20W             |              |
| T1-EM-B30-155 |                | 30W             |              |
| T1-EM-B8-230  | 156-230Vdc     | 8W              |              |
| T1-EM-B15-230 |                | 15W             |              |
| T1-EM-B20-230 |                | 20W             |              |
| T1-EM-B30-230 |                | 30W             |              |

MODEL LIST

FUNCTION

Indicator Light

AC Operation - indicator light will stay ON.

Emergency Operation - indicator light will flash slowly (light ON for 2 seconds, and light OFF for 2 seconds).

Failure - indicator light will flash quickly (light ON for 0.2 seconds, and light OFF for 0.2 seconds).

Caution:

Before doing high-voltage insulation test, you must remove the battery pack first and make sure there are no contacts between the battery pack and the LED drivers.

During storage, the battery pack needs 24 hours charge every 6 months.



T-1 LIGHTING

# FLASH RELIABLE EMERGENCY DRIVERS

T1-EM-B

## EM DRIVER HOUSING

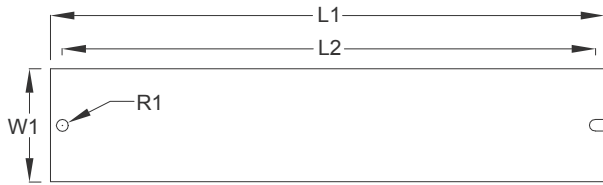

| LENGTH |       | WIDTH |  | HEIGHT | RADIUS |       |
|--------|-------|-------|--|--------|--------|-------|
| L1     | L2    | W1    |  | 1"     | R1     |       |
| 7"     | 7.07" | 1.5"  |  |        |        | 0.08" |

## LI-ION BATTERY HOUSING

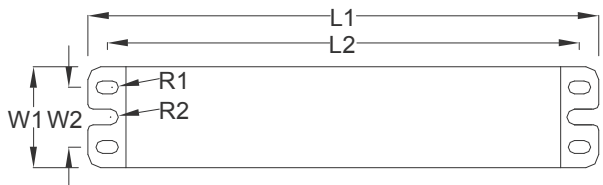

| POWER   | LENGTH |       | WIDTH |       | HEIGHT | RADIUS |      |
|---------|--------|-------|-------|-------|--------|--------|------|
|         | L1     | L2    | W1    | W2    |        | R1     | R2   |
| 4W - 8W | 4.02"  | 3.58" | 1.69" | 0.67" | 1.22"  | 0.8"   | 0.8" |

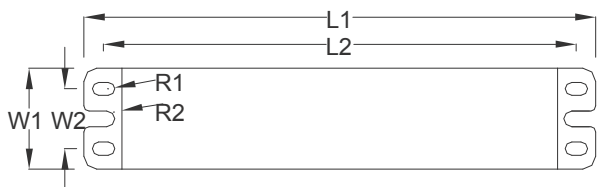

| POWER     | LENGTH |       | WIDTH |       | HEIGHT | RADIUS |      |
|-----------|--------|-------|-------|-------|--------|--------|------|
|           | L1     | L2    | W1    | W2    |        | R1     | R2   |
| 15W - 20W | 7.03"  | 6.43" | 1.61" | 0.91" | 0.98"  | 0.1"   | 0.1" |
| 30W       | 7.03"  | 6.43" | 1.61" | 0.91" | 1.73"  | 0.1"   | 0.1" |

## NI-MH BATTERY HOUSING

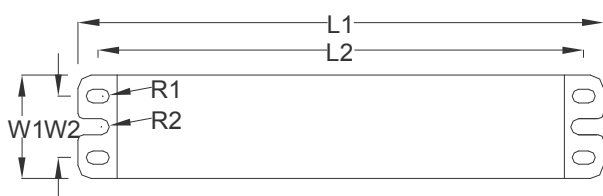

| POWER    | LENGTH |       | WIDTH |       | HEIGHT | RADIUS |      |
|----------|--------|-------|-------|-------|--------|--------|------|
|          | L1     | L2    | W1    | W2    |        | R1     | R2   |
| 8W - 20W | 7.03"  | 6.43" | 1.61" | 0.91" | 1.73"  | 0.1"   | 0.1" |

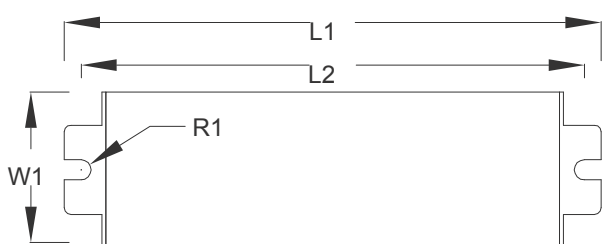

| POWER   | LENGTH |        | WIDTH |       | HEIGHT | RADIUS |       |
|---------|--------|--------|-------|-------|--------|--------|-------|
|         | L1     | L2     | W1    | W2    |        | R1     | R2    |
| 4W - 8W | 7.03"  | 8.41"  | 1.38" |       | 0.98"  | 0.09"  |       |
|         | 7.03"  | 7.09"  | 1.69" | 0.67" | 1.22"  | 0.08"  | 0.08" |
| 15W     | 12.01" | 11.81" | 1.54" |       | 0.93"  | 0.09"  |       |
| 30W     | 7.09"  | 6.38"  | 2.83" |       | 1.77"  | 0.1"   |       |

DIMENSIONS



T-1 LIGHTING

# FLASH RELIABLE EMERGENCY DRIVERS

T1-EM-B

WIRING DIAGRAM 1

(This wiring diagram is suitable for LED lamps with power less than 120W and the output with power less than 300W and turn off wall switch before testing )

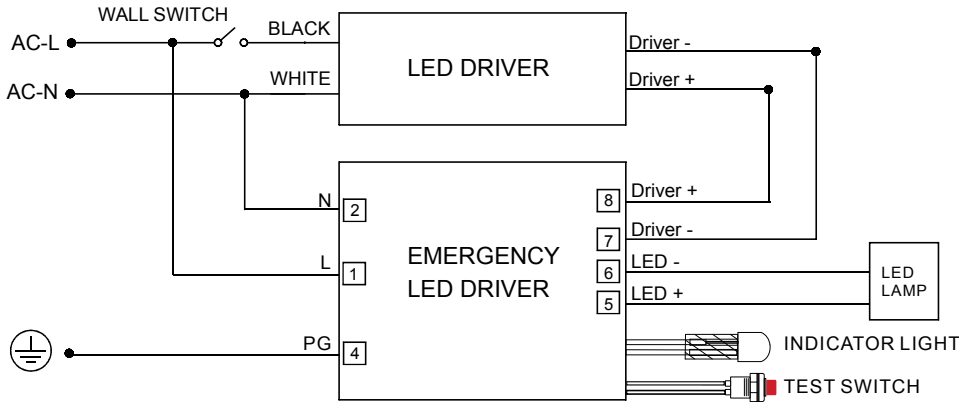

WIRING DIAGRAM 2

(This wiring diagram is suitable for LED lamps with power less than 300W and turn off wall switch before testing )

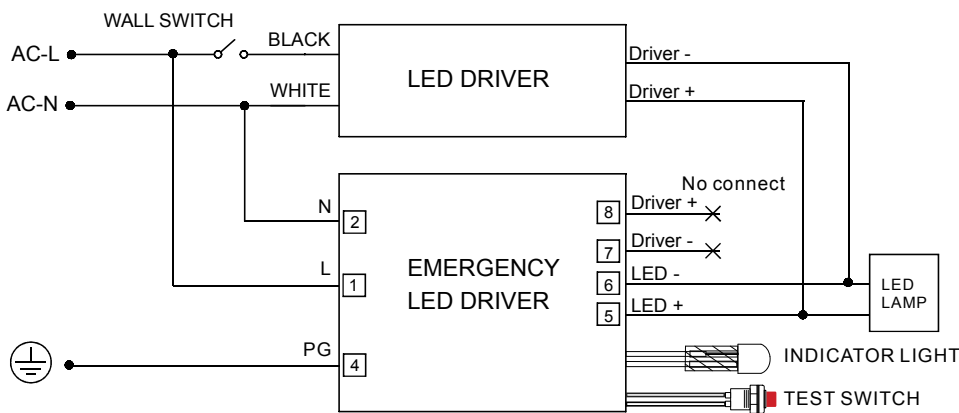

WIRING DIAGRAM

### Self-Test

The emergency LED driver contains a control/monitor circuit which will perform a 40-second discharge test once a month, and a fully discharge test once a year. At this time, the unit will simulate an AC power failure and automatically switch to emergency mode. During routine testing, the unit will monitor the operation of the LED load, battery voltage, and emergency duration, and if the unit detects any problems, the indicator will flash quickly.