

Project	Catalog #
Distributor	Type
Prepared by	Date



On/Off High Bay Microwave Sensor

T1-SS119-MIC-ON-OFF

The **T1-SS119-MIC-ON-OFF** is a microwave (MIC) sensor ideal for high bay installation. It has a mounting height of 50ft with a range of 30ft and 360° radius at a working frequency of 5.8GHz. It has the advantage of having a stable working temperature of -40° ~ +70°C.

SPECS

Operating Voltage	120/277 VAC, 50Hz/60Hz	Detection Radius	30ft
Maximum Load	Resistive/Halogen - 800W@120V / 1200W@277V Fluorescent Ballast - 660W@120V / 1200W@277V Electronic Ballast (LED/CFL) - 5A@120V / 5A@277V	Detection Angle	360°
HF System	5.8GHz CW	Mounting Height	Max 50ft
		Time Setting	10sec.-60min. (adjustable)
		Light Control	10-2000Lux (adjustable)
		Humidity	Max. 95% RH
		Temperature	-40°F ~ +158°F (-40°C ~ +70°C)
		Warranty	Five Year Warranty

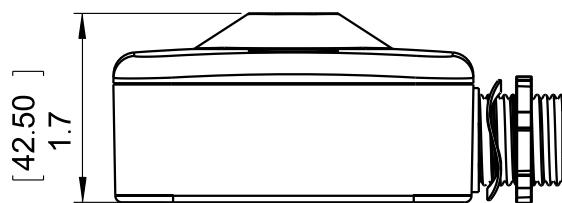
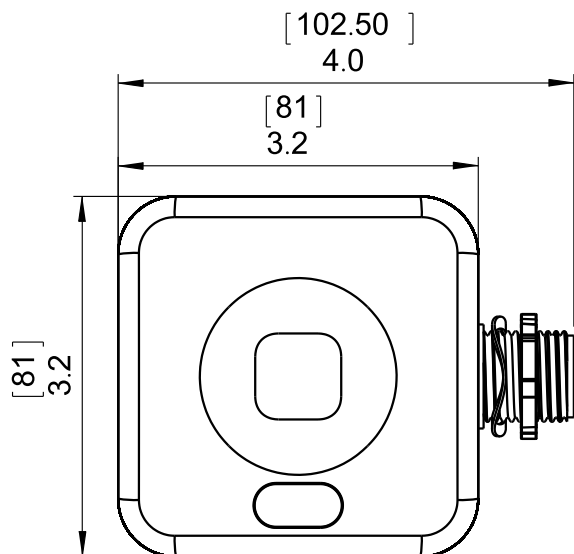

DIMENSIONS

⚠ WARNING

NOTE: Warm-up time is 15 seconds the first time. After the sensor connects, the light will turn on for 15 seconds.

NOTE: Factory default setting: 100% sensitivity.
Hold On Time: 10sec
Daylight Sensor: disabled

NOTE: The LED set light will blink as a confirmation that the setting has been changed on the DIP switch.

COVERAGE

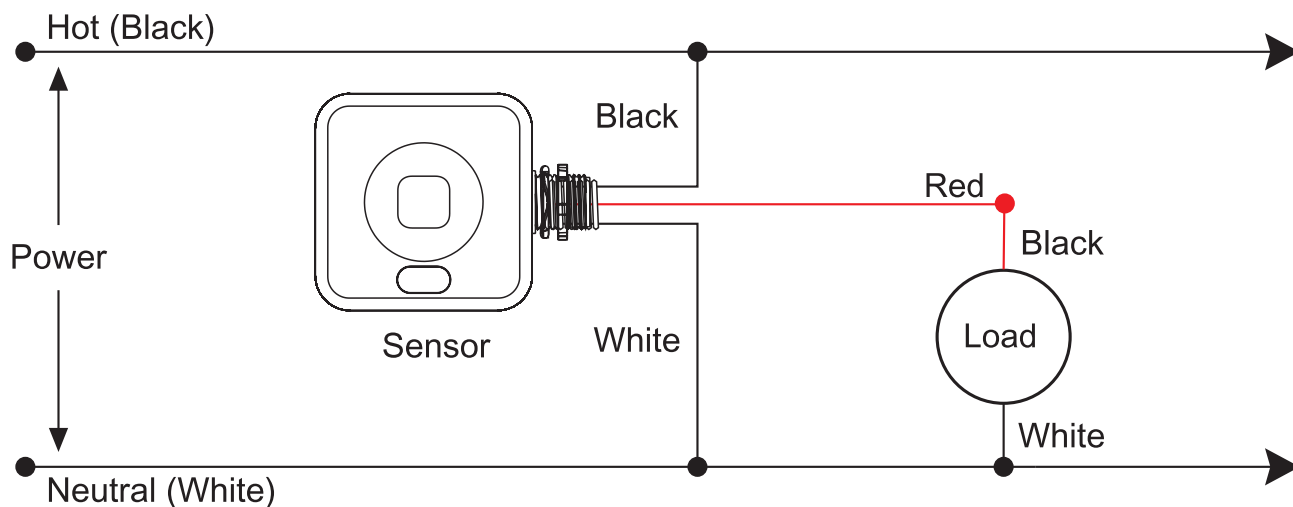
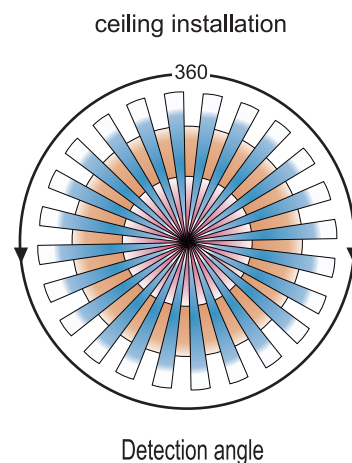
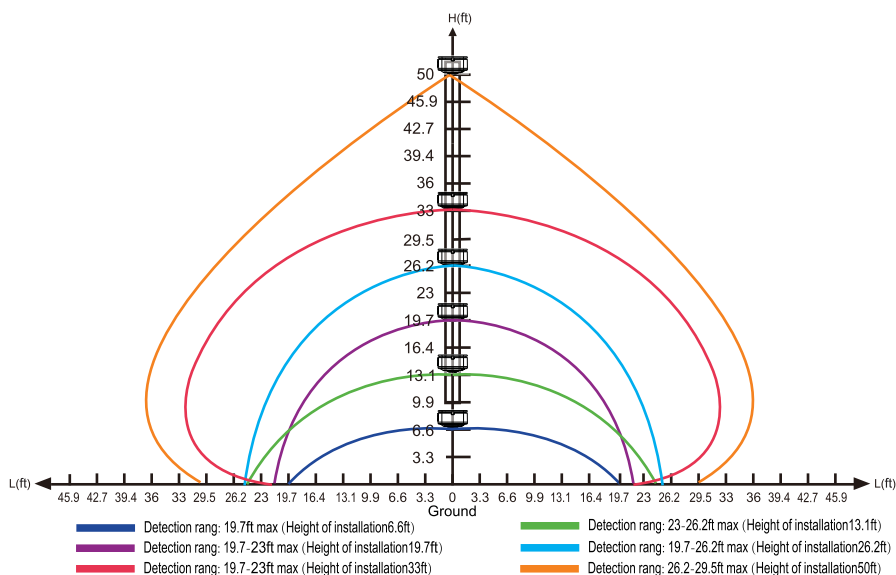

WIRING DIAGRAM

Shown on the diagram: 1, 2, 3 sets detection range; 4, 5, 6, and 7 sets the delay time; and 8, 9, 10 sets the light-control.

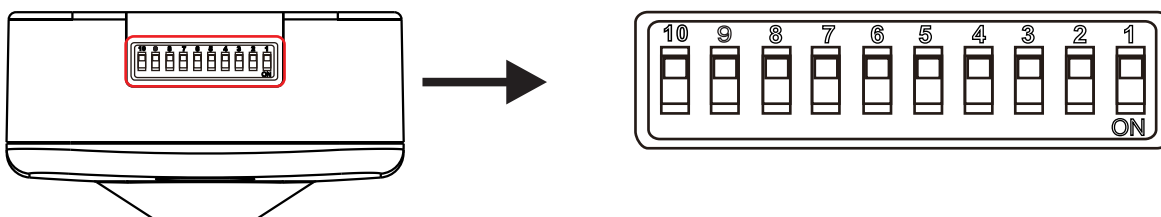

DETECTION SENSITIVITY SETTING

Detection range is the term used to describe the radius of the circular detection zone at a height of 40ft.

Pull switch to the OFF position as "↑", pull switch to the ON position as "↓". See diagram below to adjust to the desired sensitivity.

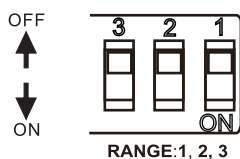

SENSITIVITY			
3	2	1	
↑	↑	↑	20%
↓	↓	↑	50%
↓	↑	↓	75%
↓	↓	↓	100%

HOLD TIME SETTING

The light can be set to stay ON between approximately 10sec to a maximum of 30min. Any movement detected before this time elapses will restart the timer. It is recommended to select the shortest time for adjusting the detection zone and for performing a walk test.

Pull switch to the OFF position as "↑", pull switch to the ON position as "↓". See diagram below to adjust the desired hold time.

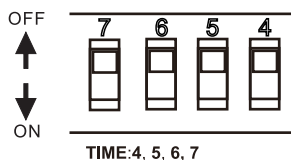

TIME				
7	6	5	4	
↑	↑	↑	↑	10S
↓	↑	↑	↑	1Min
↑	↑	↓	↑	5Min
↓	↑	↓	↑	10Min
↓	↑	↑	↓	30Min

LIGHT-CONTROL SETTING

The selected light-control response threshold can be set from 10lux to 300lux.

Pull switch to the OFF position as "↑", pull switch to the ON position as "↓". See diagram below to adjust light control.

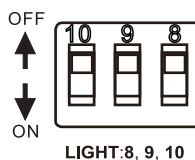

LIGHT			
10	9	8	
↑	↑	↑	☀ (light sensor disable)
↓	↑	↑	10Lux
↓	↓	↑	50Lux
↑	↓	↓	300Lux